

# BullsEye™ Installation Instructions

- 700150 - JD 7000, Kinze (Not EdgeVac), White 8000 (vSet 2 only)
- 700155 - White 5100, 6000 & 8000 Series
- 700158 - Monosem
- 700160 - JD 7200/1700/XP
- 700280 - White 9000 & PP Ready Row Unit

**Step 1**

Remove the old seed tube from the row unit. Cut the zip ties that are holding the sensor to the tube.

If you have 1/2" sensors, add the two eye adapters as shown below in Figure 1.

**Step 2**

Position the sensor onto the BullsEye seed tube in the same position and direction that it was on the old tube. Use the zip ties provided to secure the sensor to the seed tube.



**Step 3**

Make sure that the area around the pin where the seed tube hooks is clear of dirt and debris. Install the BullsEye Seed Tube into the row unit making sure that the hook is over the pin. Secure the tube with the same pin and clip that held the old tube in place.

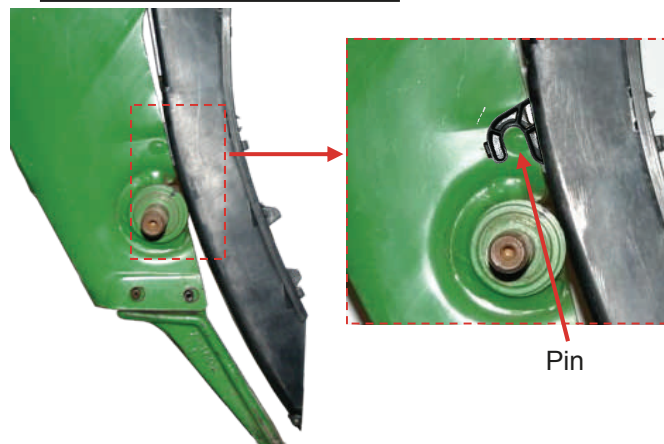
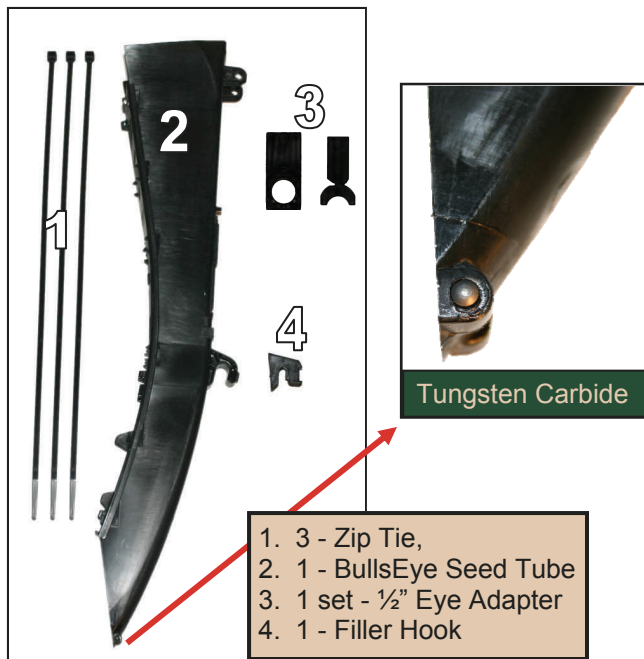

## 1/2" - Eye Adapter

Fig 1



Use 1 set of the 1/2" adapters per tube to reduce the hole for 1/2" sensor eyes. Snap into place as shown to the right.

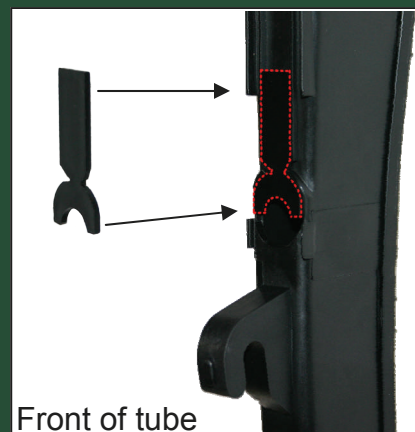

Questions? Check the website: [www.precisionplanting.com](http://www.precisionplanting.com) or call us at 309-925-5050.

## Shim Tree Directions

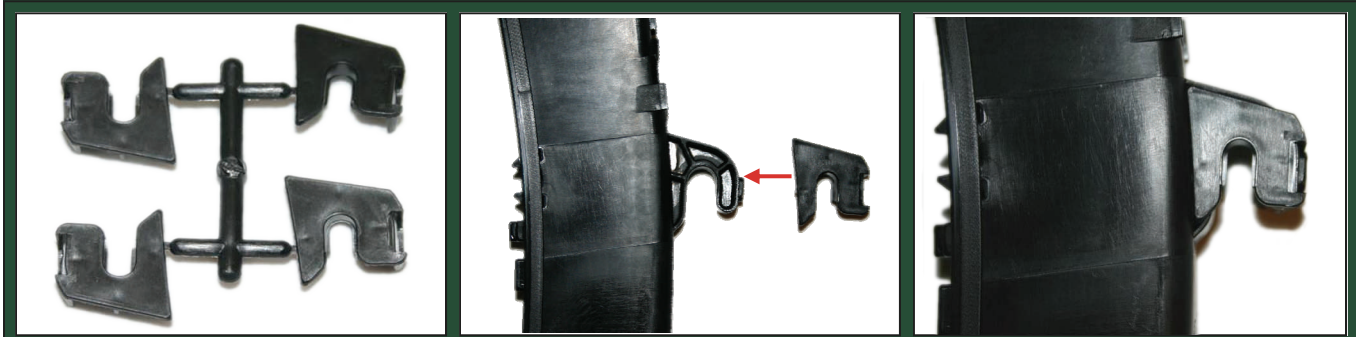

**Special instructions for JD 1700 and 7200 Series row units:** Install the reduction adapter into the hook of the BullsEye seed tube. These row units have a smaller diameter pin that the seed tube hooks over. Just push the adapter into the open side of the hook. Then install the tube as described in step 3.



**Special instructions for JD seed tubes with tabs:** Many JD tubes use a plastic tab to secure the tube to the row-unit frame. The BullsEye Seed Tube uses a more secure pin and clip. You can get the pins and clips from your Precision Planting dealer.

### JD1700/7200

Accessory Part # 700167



Sold in Packages of 4

The spring pin is needed to mount the BullsEye Seed Tube to a 2007- John Deere planter.

### JD1700/7200

(-2006)

Accessory Part # 700137

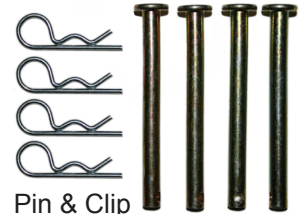

Pin & Clip

Sold in Packages of 4

The pin & clip is needed to mount the BullsEye Seed Tube to a JD 1700 & 7200 Series planter.

### White 5100

This modification is made to prevent any interference between the meter and the seed tube.

Cut 1/8" off the top all the way around on all four sides.



**Warranty:** Precision Planting, Inc. warrants this product to be free from defects in material or workmanship during the first year of service. Our obligation under this warranty shall be limited to repairing or replacing, free of charge to the original purchaser, any part that in our judgment shall show evidence of such defect, provided further that such part shall be returned within thirty (30) days from the date of failure – routed through the dealer from whom the purchase was made. Shipping charges prepaid.

Precision Planting shall have no obligation or liability of any kind on account of any of its equipment and shall not be liable for special or consequential damages. This warranty does not extend to loss of crops, loss because of planting delays or any expense or loss incurred for labor, supplies, substitute machinery, rental or for any other reason. Precision Planting makes no other warranty, express or implied.

**Questions? Check the website: [www.precisionplanting.com](http://www.precisionplanting.com) or call us at 309-925-5050.**